



pearson
ferrier®



211 BURY ROAD
Bury, BL8 3DY

Offers In The Region Of £150,000

211 BURY ROAD

Property at a glance

- STONE FRONTED TERRACE
- TWO BEDROOMS
- TOTTINGTON VILLAGE
- IDEAL FIRST TIME BUY OR BUY TO LET
- NO ONWARD CHAIN
- IN NEED OF COSMETIC IMPROVEMENT

Stone fronted, two bedroom terraced cottage property located in the ever popular village of Tottington on Bury Road. The property is in need of modernisation offering you the chance to put your stamp on your new home or an ideal renovation project. The location offers excellent transport links to Bury town centre and is within walking distance of Tottington Village with its local shops, health centre, bars and restaurants with Kirklees Nature trail and Walshaw sports club being on your doorstep. In brief the property comprises of; Living room, kitchen, two bedrooms and family bathroom with garden to the front & rear and is offered to the market with no onward chain.

Leasehold - 999 years from 25 March 1870
Council Tax Band - B
EPC - C







Floor 0

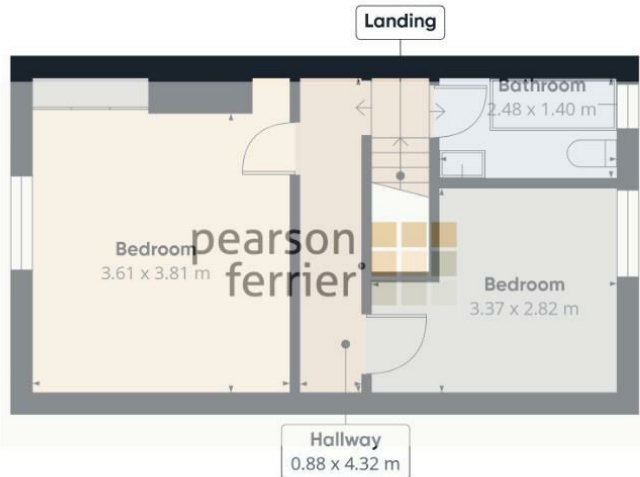

Floor 1

Approximate total area⁽¹⁾
66 m²

(1) Excluding balconies and terraces

Calculations reference the RICS IPMS 3C standard. Measurements are approximate and not to scale. This floor plan is intended for illustration only.

GIRAFFE360

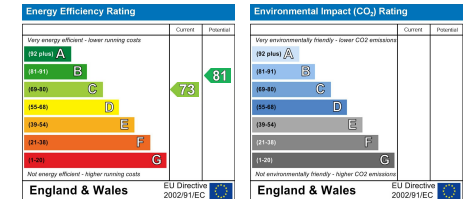

Bury Office
435/7 Walmersley Road, Bury, Lancashire, BL9 5EU
Telephone: 0161 764 4440
Fax: #
Email: bury@pearsonferrier.co.uk

www.pearsonferrier.co.uk



All statements contained in these particulars are for indicative purposes only and are made without responsibility on the part of Pearson Ferrier and the vendors of this property and are not to be relied on as statements or representations of fact. Potential purchasers should satisfy themselves by inspection or otherwise as to the accuracy of such details contained in these particulars.